

**ELETTROVALVOLE  
SPOOL VALVES**

**EVJ51 - EVJ52**

**EVJ51** (G551C501GD+30215106IAD2 - internal reference)

**ELETTROVALVOLA A SINGOLO SOLENOIDE, A SICUREZZA INTRINSECA**  
**SINGLE COIL SPOOL VALVE, INTRINSICALLY SAFE**

**COMANDO MANUALE DI SICUREZZA**  
**MANUAL OVERRIDE OPERATION**

**IP 65**



**SIL  
CERTIFICATION**  
On request

**ATEX**

II 1 G Ex ia IIC T6 to T4 Ga  
II 1 D Ex ia IIIC T85°C to T135°C Da

(internal reference - G551C502GD+30215106IAD2) **EVJ52**

**ELETTROVALVOLA A DOPPIO SOLENOIDE, A SICUREZZA INTRINSECA**  
**TWO COILS SPOOL VALVE, INTRINSICALLY SAFE**

**DIPONIBILI CON SILENZIATORI IN OTTONE O IN PLASTICA.**  
**DISPONIBILI CON SILENZIATORI RIDUTTORE DI FLUSSO.**  
**AVAILABLE WITH BRASS OR PLASTIC SILENCERS.**  
**AVAILABLE WITH FLOW NOISES SUPPRESSOR REDUCING.**

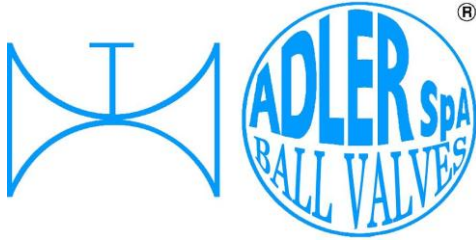

## ELETTROVALVOLE SPOOL VALVES **EVJ51 - EVJ52**

**EVJ51 – SINGLE COIL SOLENOID VALVE** (G551C501GD+30215106IAD2 - internal reference)

**EVJ52 – TWO COILS SOLENOID VALVE** (G551C502GD+30215106IAD2 - internal reference)

### CARATTERISTICHE GENERALI / GENERAL FEATURES

- Elettrovalvola a comando servoassistito con raccordi filettati e piano di posa secondo NAMUR:
- Singolo solenoide mod. **EVJ51 - monostabile**;
- Doppio solenoide mod. **EVJ52 - bistabile**.
- Dispositivo di azionamento manuale dell'elettrovalvola, azionabile con cacciavite.
- Adatto alle funzioni 3/2 NC e 5/2 per il comando di attuatori a semplice e doppio effetto.
- Attacchi filettati in accordo DIN 43650, forma C, 9,4 mm.
- Montaggio mediante 2 fori in accordo allo standard NAMUR e VDI/VDE 3845.
- Temperatura di funzionamento:  
-10°C < T < +40°C
- La valvola offre protezione contro l'ingresso di liquidi, polveri o altro materiale estraneo.
- Ritorno a molla.
- Elettrovalvole conformi alle Direttive CE applicabili.
- Su richiesta, elettrovalvole conformi alla norma IEC 61508 di sicurezza funzionale, utilizzabili fino a SIL 3.
- Peso: 330 gr (EVJ51) – 400 gr (EVJ52)
- *The spool valves have threaded port connections and NAMUR style interface:*
- *Single coil mod. **EVJ51 - monostabile**;*
- *double coil mod. **EVJ52 - bistable**.*
- *Manual override operation, it can be operated with screwdriver.*
- *The same spool valve can be adapted for 3/2 NC or 5/2 function for controlling double-acting and single acting actuators.*
- *Connecting according to DIN 43650, form C, Ø 9,4 mm .*
- *Assembly with 2 holes according NAMUR standard and according VDI/VDE 3845.*
- *Operating temperature:*  
*-10°C < T < +40°C*
- *The spool valve offers environmental protection against the ingress of liquids, dust or any other foreign matter.*
- *Valves with spring return.*
- *The solenoid valves satisfy all relevant EC Directives.*
- *On request, spool valve compliant with IEC 61508 functional safety standard, usable up to SIL3.*
- *Weight: 330 gr (EVJ51) – 400 gr (EVJ52)*

### SPECIFICHE PNEUMATICHE / PNEUMATIC SPECIFICATIONS

- **Pressione di utilizzo:**  
Pmin: 2 bar  
Pmax: 8 bar.
- **Caratteristiche di passaggio:**  
Ø passaggio: 6mm.  
Coefficiente di portata kv: 10 l/min (0.6 m3/h).
- **Fluido di funzionamento:**  
• Fluidi: aria, gas neutri, filtrati (50µm), senza condensa (punto rugiada -20°C).
- **Operating pressure:**  
Pmin: 2 bar  
Pmax: 8 bar.
- **Flow diameter:**  
Orifice size: Ø 6mm.  
Flow coefficient kv: 10 l/min (0.6 m3/h).
- **Operating media:**  
Fluids: air, inert gas, filtered (50µm), without condensate (dew point -20°C).

### MATERIALE / MATERIAL

- **Corpo:**  
Alluminio anodizzato nero.
- **Testata (ritorno a molla) e piastre interfaccia:**  
PA caricata fibre di vetro.
- **Parti interne:**  
Zamak, acciaio inox, POM, alluminio.
- **Testata pilota:**  
Alluminio.
- **Body:**  
Aluminium, black anodized.
- **End cover (spring) and interface plates:**  
Glass-filled PA.
- **Internal parts:**  
Zamak, stainless steel, POM, aluminium.
- **Pilot end cover:**  
Aluminium.

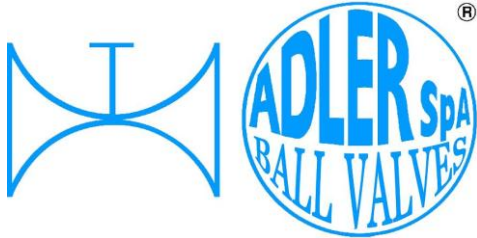

# ELETTROVALVOLE SPOOL VALVES **EVJ51 - EVJ52**

**EVJ51 - SINGLE COIL SOLENOID VALVE** (G551C501GD+30215106IAD2 - internal reference)  
**EVJ52 - TWO COILS SOLENOID VALVE** (G551C502GD+30215106IAD2 - internal reference)

## DIMENSIONI ELETTROVALVOLA / SPOOL VALVE DIMENSIONS

Comando manuale / Manual operator

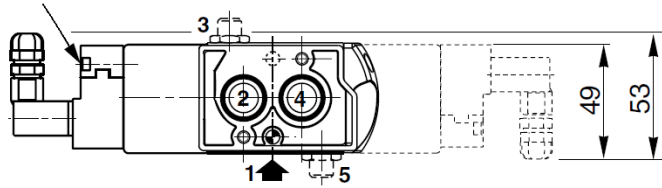

**EVJ51**

**EVJ52**

Porta di sfiato / Pilot exhaust port

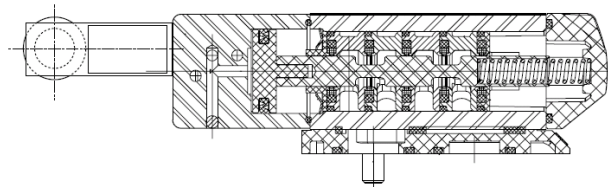
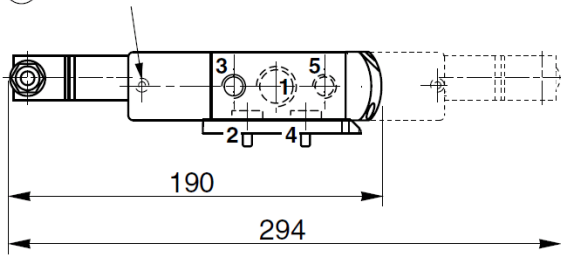

### LEGENDA / LEGEND



|  |  |
|--|--|
| - Fori di alimentazione [1] e di scarico [3,5]: filettati G 1/4 (ISO 228/1);             | - Supply [1] and exhaust [3, 5] holes: threaded G 1/4 (ISO 228/1);                 |
| - Fori di scarico [3, 5]: possibilità di montaggio silenziatore in ottone o in plastica; | - Exhaust holes [3, 5]: available for mounting brass or plastic exhaust silencers; |
| - Comando manuale di emergenza;  | - Manual operator;   |
| - Fori di utilizzo [2, 4] completi di O-Ring   | - Operating holes [2, 4]: supplied with O-Ring                                     |
| - 2 fori di fissaggio Ø 5,3 mm (B): lamatura Ø 9 mm, profondità 5 mm;                    | - 2 mounting holes Ø 5,3 mm (B): spotfacing Ø 9, depth 5 mm;                       |

## SOLENOIDE 30215106IAD / SOLENOID 30215106IAD

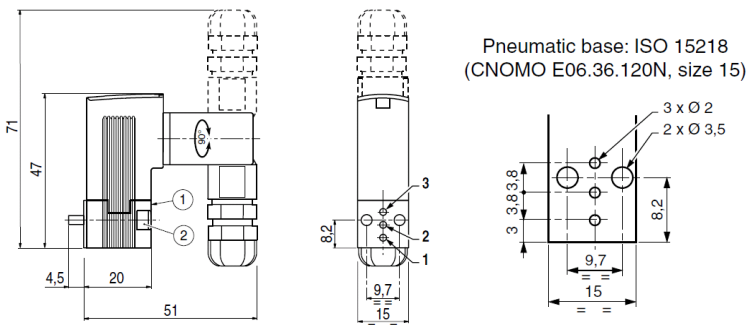

- **Corpo solenoide / solenoid enclosure**  
Para
- **Parti interne / internal parts**  
POM, PET, acciaio inox e ottone  
POM, PET, stainless steel and brass
- **Tenute / seals**  
NBR, FPM
- **Guarnizioni interfaccia pneumatica / Pneumatic interface seal**  
TPE
- **Tensioni disponibili / Available voltages**  
DC: 12-24 V

| pipe size<br>(mm) | flow<br>at 6 bar<br>l/min (ANR) |       | coefficient<br>Kv |       | operating pressure<br>differential<br>(bar) |                  | power<br>level<br>(=) | basic catalogue number<br>with impulse /maintained<br>manual operator<br>= |
|-------------------|---------------------------------|-------|-------------------|-------|---|------------------|-----------------------|--|
|                   | 1 → 2                           | 2 → 3 | 1 → 2             | 2 → 3 | min.  | max. (PS)<br>(=) |                       |  |
| 0,6               | 11                              | 20    | 0,21              | 0,44  | 0   | 8                | LP                    | 30215106IAD  |

20010 S. STEFANO TICINO (MI) ITALY V.le BORLETTI, 14 Tel. +39/02974842.11 FAX +39/0297271698  
 E-mail: [adler@adlerspa.com](mailto:adler@adlerspa.com) <http://www.adlerspa.com>

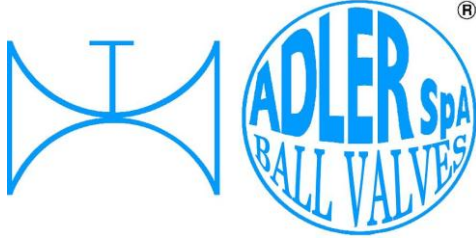

# ELETTRIVALVOLE SPOOL VALVES **EVJ51 - EVJ52**

## CARATTERISTICHE ELETTRICHE / ELECTRICAL FEATURES

- Disponibili bobine:  
12V DC 0,5 W (ON REQUEST)  
24V DC 0,5 W
- Classe di protezione: IP 65
- Connessione elettrica: DIN 43650, 9,4 mm, forma C per cavo Ø 4-6mm
- Solenoide attivo 100% ED;
- Bobina con classe di isolamento F;
- Connettore approvato ATEX-IECEX.
- Available coils:  
12V DC 0,5 W (ON REQUEST)  
24V DC 0,5 W
- Class protection: IP 65
- Electrical connection: DIN 43650, 9,4 mm, form C for cable Ø4-6 mm
- Duty cycle: 100% ED, continuous operation;
- Coil isolation class F;
- IECEx-ATEX approved cable entry device.

| voltage (U <sub>n</sub> )<br>(maximum ripple 10%) | power rating (P <sub>n</sub> ) <sup>(*)</sup><br>hot/cold = | typical functional ratings      |                        |                                |                             |                             | ambient temperature range (TS) | type <sup>(3)</sup> |
|---|---|---------------------------------|------------------------|--------------------------------|-----------------------------|-----------------------------|--------------------------------|---------------------|
|   |   | I <sub>(ON)</sub> min. with LED | U <sub>(ON)</sub> min. | U <sub>(MAX)</sub> recommended | U <sub>(OFF)</sub> turn off | I <sub>(OFF)</sub> turn off |                                |                     |
| (V)   | (W)   | (mA)                            | (V)                    | (V)                            | (V)                         | (mA)                        | (°C) <sup>(1)</sup>            |                     |
| LP1 "12V"   | 0,5   | 33                              | 11,9                   | 23                             | 3,3                         | 10                          | -10 to +40/50/60               | 01-02               |
| LP1 "24V"   | 0,5   | 25                              | 16,4                   | 28                             | 5,7                         | 7                           |                                |                     |

<sup>(\*)</sup> Nominal power ratings with LED indicator and electrical protection.

| P <sub>n</sub> | safety parameters     |                |                |                |                |
|----------------|-----------------------|----------------|----------------|----------------|----------------|
|                | U <sub>i</sub> = (DC) | I <sub>i</sub> | P <sub>i</sub> | L <sub>i</sub> | C <sub>i</sub> |
| (W)            | (V)                   | (mA)           | (W)            | (mH)           | (µF)           |
| 0,5            | 28                    | 300            | 1,6            | 0              | 0              |

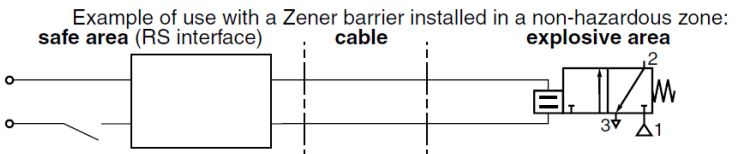

## TEMPERATURE CLASSIFICATION TABLE DC (=)

| P <sub>i</sub><br>(watt) | maximum ambient °C <sup>(1)</sup> |     |             |     |             |     | insulation class F (155°C) 100% E.D. <sup>(2)</sup> |  |
|--------------------------|-----------------------------------|-----|-------------|-----|-------------|-----|---|--|
|                          | surface temperature               |     |             |     |             |     |   |  |
|                          | T6<br>85°C                        |     | T5<br>100°C |     | T4<br>135°C |     |   |  |
|                          | 12V                               | 24V | 12V         | 24V | 12V         | 24V |   |  |
| 0,5                      | 40                                | 40  | 50          | 60  | 60          | 60  | single solenoid valve                               |  |
|                          | -                                 | -   | -           | -   | 50          | 50  | solenoid valve mounted in series                    |  |

- <sup>(1)</sup> Minimum ambient temperature: -10°C
- <sup>(2)</sup> Coil designed for permanent duty within maximum ambient temperature limits. The solenoid valve must be connected to a special certified electrical supply unit installed in a non-dangerous zone. List of safety barrier manufacturers on the following page.
- <sup>(3)</sup> Refer to the dimensional drawings on page 4.